



INAUGURAL

Gullah Geechee and
African Diaspora Conference
March 6-9, 2019

Coastal Carolina University

This conference would not have been possible without the generous support of the following organizations:

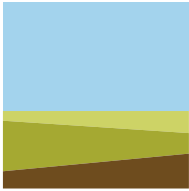

GAYLORD AND
DOROTHY DONNELLEY
FOUNDATION



And our partners at Coastal Carolina University:

The Burroughs Fund for Southern Studies **The Athenaeum Press**

The Department of Anthropology and Geography **Office of Diversity and Inclusion Services**

Conference Committee

Eric Crawford, Chair
Richard Aidoo
Alli Crandell
Carolyn Dillian
Amy Edmunds
Veronica Gerald

Maggi Morehouse
David Palmer
Amy Tully
Gwendolyn Schwinke
Joy Young

Contents

Welcome	3
Featured Speakers	2
Schedule at a Glance.....	8
Shuttle Schedule	10
Maps	11
Full Schedule	
Wednesday.....	19
Thursday.....	23
Friday	29
Saturday	35
Dining Options.....	37
Note Paper.....	39

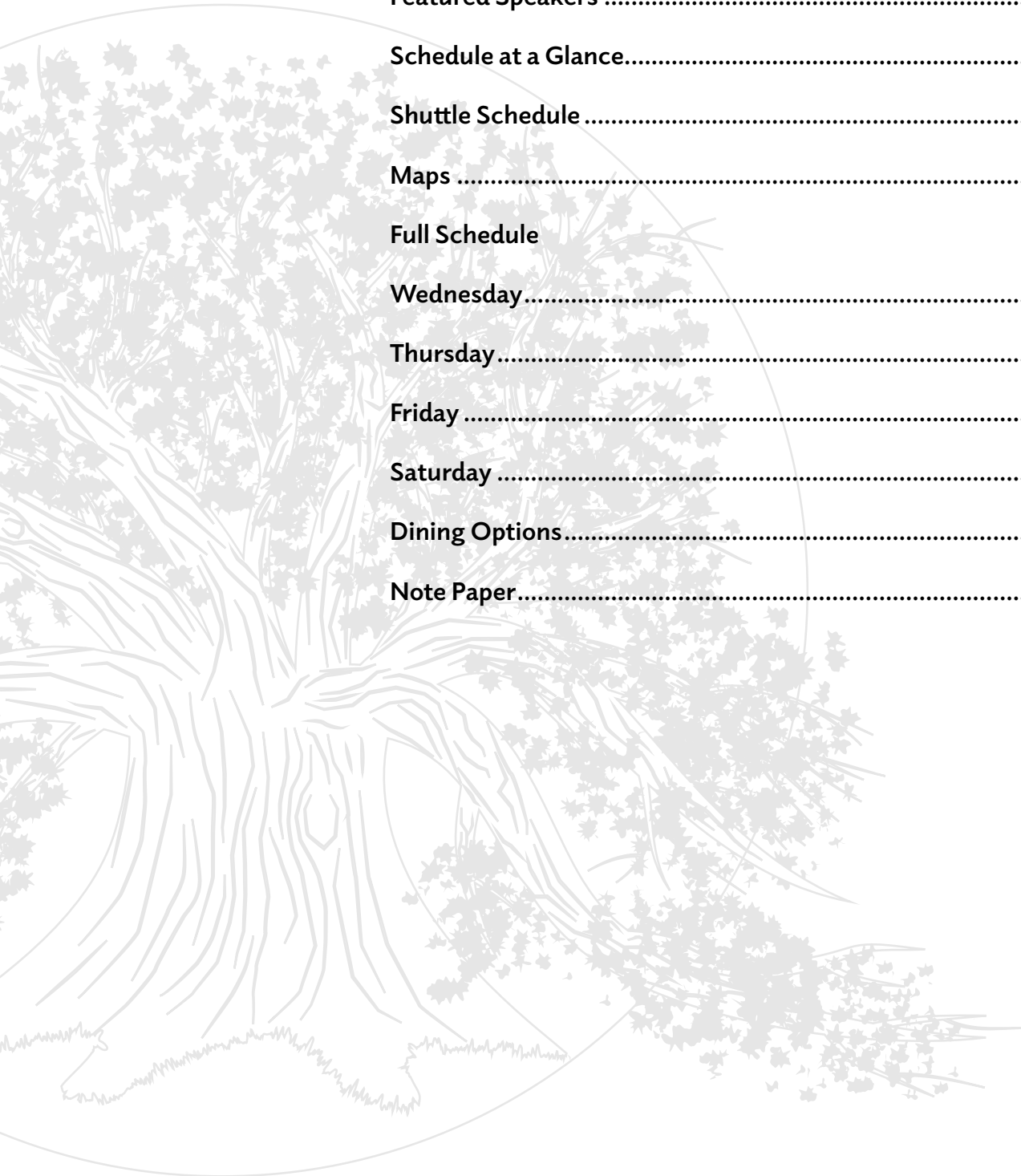

Coastal Initiatives

Charles Joyner Institute for Gullah and African Diaspora Studies

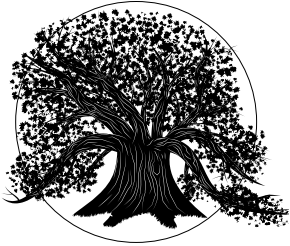

The Charles Joyner Institute for Gullah and African Diaspora Studies examines the historical migration and scattering of African populations to local geographical areas and the subsequent evolution of blended cultures, specifically Gullah. CCU's location at the northern tip of the Gullah/Geechee Cultural Heritage Corridor puts it in a unique position for diaspora study and research. The work of the institute provides students with experiential learning opportunities, both at home and abroad, that center on interconnections among local, national and global peoples and their societies.

Learn more: coastal.edu/joynerinstitute

The Athenaeum Press at Coastal Carolina University



The Athenaeum Press is a student-driven publishing lab that offers students professional-level, hands-on experience in authoring, designing and producing innovative stories about our region. Rather than accepting completed manuscripts for publishing, the press accepts project proposals that will be intensely developed by an interdisciplinary, collaborative group of students and faculty. The press gathers these proposals from all corners of the community. Project initiators, or those that submit project proposals, will extensively collaborate with the press team to design, build and produce professional-quality content using unique and innovative technologies and media formats.

Learn more: theathenaeumpress.com

Rebecca Randall Bryan Art Gallery

Zora J Murff | Corrections

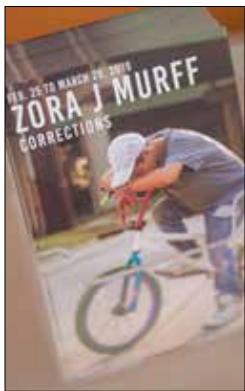

Combining his education in human services and art, Murff's photography focuses on how images are used to reinforce social and cultural constructs including race and criminality. Murff's work has been exhibited internationally and featured online including in Aperture Magazine, The New Yorker, The British Journal of Photography and the New York Times. Murff earned his M.F.A. in studio art from the University of Nebraska at Lincoln and holds a Bachelor of Science in psychology from Iowa State University. He is currently visiting assistant professor of photography at the University of Arkansas.

Gallery Hours: 9 a.m.-5 p.m.

On behalf of the Coastal Carolina University family, I warmly welcome you to the inaugural International Gullah Geechee and African Diaspora Conference. This year's theme is "Tracing the African Diaspora: Places of Suffering, Resilience and Reinvention."

Since Coastal Carolina University launched the Charles Joyner Institute for Gullah and African Diaspora Studies—the only institute of its kind in the nation—in 2016, it has been a dream of mine to have such a gathering of accomplished scholars who share my passion in studying and ultimately celebrating the many cultural connections that bind peoples within the African diaspora. From such critical dialogues we are able to recontextualize the past and remove the many untruths and stigmas associated with slavery. Although it is often difficult to revisit this dark period, we must hold up to the light the brilliance and talents of these men and women who found inner freedom in their artwork, music, ring shout, literature—their culture.

Equally important are those discussions that draw interest and active participation from the younger generation. In this age of the Wakandan culture and Afrofuturism, we must show the adaptability of Gullah Geechee and African diaspora cultures to new and creative reinterpretations. In so doing, we not only ensure the survival of the global black experience but also impart to those to follow an unparalleled cultural legacy.



Eric Crawford
Director, Charles Joyner Institute for Gullah and
African Diaspora Studies
Associate Professor of Music
Coastal Carolina University



Keynote Speaker: Sheila Walker

Thursday, 10:55 am | Edwards Recital Hall (EHFA 152)

A cultural anthropologist and filmmaker, Walker is executive director of Afrodiaspora, Inc., a nonprofit organization that develops documentary films and educational materials about the global African Diaspora. Her most recent works are the documentary *Slave Routes: A Global Vision*, produced for the UNESCO Slave Route Project, and an edited book featuring articles by Afrodescendants from South America, *Afro-South Americans Speak of their Peoples and their History*. Walker was Director of the Center for African and African American Studies, the Annabel Irion Worsham Centennial Professor in the College of Liberal Arts, and Professor of Anthropology at the University of Texas at Austin, and she was the William and Camille Cosby Professor in the Humanities and Social Sciences, professor of Anthropology and Director of the African Diaspora and the World Program at Spelman College.



Edmund Abaka | Friday, 8:05 a.m. - Transatlantic Memory

Abaka is a photographer and historian of Africa at the University of Miami. He is a graduate of the University of Cape Coast in Ghana and received his master's from the University of Guelph in Canada. He received his Ph.D. from York University in 1998. He was awarded a Fulbright fellowship in 2016 to research the Hausa Diaspora in Ghana.



Anne Bailey | Friday, 5 p.m. - Enslaved Traumas and Resistance

Bailey is a writer, historian and professor of history and Africana Studies at SUNY (State University of New York) Binghamton. In her works of nonfiction, she combines elements of travel, adventure, history, and an understanding of contemporary issues with an accessible style. She is a U.S. citizen who grew up in Jamaica and in Brooklyn, New York.



Jessica Berry | Saturday, 8 a.m. - Talk yuh Talk

Berry works at the Department of Health Sciences at South Carolina State University. She does research in sociolinguistics, morphology and higher education. Her most recent publication is "Dialect Variation of Copula and Auxiliary Verb BE: African American English-Speaking Children With and Without Gullah/Geechee Heritage."



Rhonesha Blanché | Thursday, 1:05 p.m. - African Diaspora Consortium

Blaché has worked in the field of education for 20 years. As a passionate educator, she has purposely diversified her experience by working with students at each level from PreK-Adult Reentry, public to private, rural to urban, small to large, traditional to alternative and local to international populations from Africa, Europe, the Caribbean and the U.S.

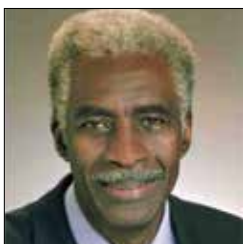

Emory Campbell | Friday, 11:05 - Toward an Understanding of Gullah Geechee Culture

Campbell is Executive Director Emeritus of Penn Center, located on St. Helena Island, S.C. During his 22-year tenure, he preserved and enhanced the unique and rich Gullah Geechee cultural and environmental heritage in the Sea Islands. Campbell has appeared in many documentaries, news magazines, films and radio and television programs and is currently the director of the Gullah Heritage Consulting Service.



Melissa Cooper | [Friday, 3:20 p.m. - Gullah Folklore and Rootwork](#)

Cooper is a writer, historian and professor. She is the author of the groundbreaking historical study *Making Gullah: A History of Sapelo Islanders, Race, and the American Imagination* (University of North Carolina Press, 2017), which was reviewed in *The New Yorker* (May 29, 2017) and featured in *Upscale Magazine* (June 2017) and the *Atlanta Journal Constitution* (August 2017).



Edda Fields-Black | [Friday, 5 p.m. - Enslaved Traumas and Resistance](#)

Fields-Black has written numerous scholarly studies on the transnational history of West African rice farmers, including *Deep Roots: Rice Farmers in West Africa and the African Diaspora* (2008) and *Rice: Global Networks and New Histories* (2015), which was awarded the Choice Outstanding Academic Title (2015). Fields-Black has served as a consultant for the International African American Museum and the Smithsonian National Museum of African-American History and Culture.



Gregory Gardner | [Thursday, 9:30 a.m. - West African and Gullah Geechee Music](#)

Gardner earned a bachelor's and master's degree in voice from Howard University and did post-graduate study at the Maurice Ravel Academy in St. Jean-de-Luz, France, and the Summer Vocal Institute in Graz, Austria. The bass-baritone has spent much of his time performing locally and nationally, creating such roles as Tom in Gershwin's mini-opera *Blue Monday* with The New York Pops at Carnegie Hall and Belcore in the Metropolitan Opera Guild's *The Elixir of Love* (Donizetti).



Rhoda Green | [Saturday, 2:20 p.m. - Gullah Homecomings](#)

Green was born in Barbados and spent some of her formative years in Trinidad before moving to New York, then to Charleston. Her passion is finding and underscoring links between Barbados and South Carolina through working with communities in both places. Barbados awarded her the Silver Merit of Award in 2000. In 2008, she was asked to serve as Barbados' Honorary Consul to South Carolina.



Cyrus MacFoy | [Friday, 5 p.m. - Reimagining the African Diaspora](#)

MacFoy, a researcher and scientific consultant, is the author of *Medicinal Plants and Traditional Medicine in Sierra Leone*. In this work, he highlights 200 plants used to cure more than 100 diseases and illnesses. His research focuses on traditional healers' roles in combating diseases such as HIV and AIDS.

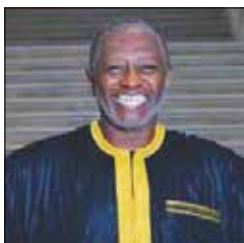

Amadu Massally | [Saturday, 2:20 p.m. - Gullah Homecomings](#)

Massally was born in Sierra Leone, and he moved to the United States for college. Since 2006, he has delved in reconnecting with descendants of Sierra Leone, especially the Gullahs. He also works to re-establish links with Trinidad and Tobago, Jamaica, Grenada, Carriacou and Petite Martinique. He is a Senior Consultant at the World Bank on a Sierra Leone diaspora initiative to galvanize their resources into investments back home.



Joe Opala | [Saturday, 2:20 p.m. - Gullah Homecomings](#)

Opala is a historian noted for establishing the "Gullah Connection," the historical links between the indigenous people of the West African nation of Sierra Leone and the Gullah people of the Low Country region of South Carolina and Georgia in the United States. Opala spent more than 40 years studying Bunce Island, the largest British slave-trading base on the Rice Coast.



Douglas Peach | Thursday, 9:30 p.m. - West African and Gullah Geechee Musical Examinations

Peach is a current Ph.D. student in ethnomusicology at Indiana University. He co-authored, with Henry Glassie and Clifford Murphy, *Ola Belle Reed and Southern Mountain Music on the Mason-Dixon Line* (Dust-to-Digital) and is the former Folklife and Traditional Arts Program Director at McKissick Museum and the South Carolina Arts Commission.



Cynthia Schmidt | Friday, 3:20 p.m. - The Language You Cry In

Schmidt is a specialist of African music and cultures. As a Fulbright Fellow in Sierra Leone (1988-90), she worked with historian Joseph Opala and linguist Taziff Koroma tracing the history of a Mende funeral song preserved by a Gullah family in coastal Georgia, which became the basis for an award-winning documentary titled *The Language You Cry In*.



Jennie L. Stephens | Saturday, 1:10 p.m. - Resolving Heirs' Property

Stephens has served as executive director of the Center for Heirs' Property Preservation since its inception in 2005. She has worked more than 25 years in the nonprofit field in such positions as sponsored programs director at a historically black college, and senior program director at Coastal Community Foundation. She also has consulted as a program reviewer, strategic plan facilitator, and grant writer. Most recently, Stephens spoke at TedXCharleston with a talk titled, "Heirs Discover Money Does Grow on Trees."



Nakia Wigfall | Saturday, 8 a.m. - Current Issues Facing Gullah Geechee Communities

Wigfall is a fifth-generation basketmaker who practices the heritage of sweetgrass basketry from her West African enslaved ancestors. Knowing the importance of the sweetgrass basket legacy, Wigfall teaches the history of this tradition as well as the necessity of preserving the natural resources used to make these baskets.



Ellen Zicholtz | Thursday, 4:30 p.m. - African Diaspora Rebellion through the Visual Arts

Zicholtz is president of the Center for Creative Partnerships. She received the 2017 Museum Leadership Award in African American History and Culture (African American Association of Museums), the 2015 Medal for Social Justice and Civil Rights (National Civil Rights Conference, Philadelphia, M.S.), and the first SC State University Faculty Creativity Award, presented by Congressman James Clyburn. She has exhibited, produced performances and been deeply involved in cultural heritage work.



Victoria Smalls | Thursday, 4:30 p.m. - The "Circle of Culture" within the Pray's House

Smalls is a cultural preservationist and public educator who serves as a federal commissioner with the Gullah Geechee Cultural Heritage Corridor. In this role, Smalls helps to recognize, sustain and celebrate the important contributions made to American culture and history by the Gullah Geechee. She serves as a commissioner with the S.C. African American Heritage Commission.

Gullah Geechee Cultural Heritage Corridor Commission

The Gullah Geechee Cultural Heritage Corridor is a federal National Heritage Area and it was established by the U.S. Congress to recognize the unique culture of the Gullah Geechee people who have traditionally resided in the coastal areas and the sea islands of North Carolina, South Carolina, Georgia and Florida—from Pender County, North Carolina, to St. Johns County, Florida. Throughout the Gullah Geechee Cultural Heritage Corridor today, there are vibrant and historic Gullah Geechee communities. We are pleased to partner with the Corridor on this conference.



Executive Director: Heather L. Hodges

Hodges became the director of the Gullah Geechee Cultural Heritage Corridor Commission in November 2017. During her tenure she has placed an emphasis on developing educational programs, supporting cultural documentation and historic preservation efforts, encouraging heritage tourism, and fostering new research. An honors graduate from the Tulane University School of Law, Hodges began her legal career in private practice in Washington, D.C., as an associate at the international law firm of Arnold & Porter LLP (now Arnold & Porter Kaye Scholer) and then as counsel with Crowell and Moring LLP. She was awarded a Women's Law and Public Policy Fellowship from Georgetown Law School in 2010. She is also a documentary photographer who specializes in shooting Diaspora culture with an emphasis on contemporary and traditional music and dance.



Dionne Hoskins-Brown, Commission Chair, Georgia
 Griffon Lotson, Commission Vice-Chair, Georgia
 David B. Frank, Commission Secretary, North Carolina
 Meredith D. Hardy, Commission Treasurer, Florida
 James R. Fullwood, North Carolina
 Sean Palmer, North Carolina
 Emory Shaw Campbell, South Carolina
 Daniel Cromer, South Carolina
 Herb Frazier, South Carolina
 Willie B. Heyward, South Carolina
 Sherman E. Pyatt, South Carolina
 Victoria A. Smalls, South Carolina
 Althea Natalga Sumpster, Georgia
 Floyd Phillips, Florida

Wednesday | Brookgreen Gardens (Murrells Inlet)

- 5-6 p.m. Performance and Tour (Ron Daise)
- 6-7 p.m. Lecture and Performance (Marlena Smalls)
- 7-8:30 p.m. Reception at the Lowcountry Center

Thursday | Coastal Carolina University (Conway)

- 7 a.m.-4:30 p.m. Registration
- 8:05-9:20 a.m. Concurrent Sessions
 - Partial Truths
 - Reinterpretations of Gullah Geechee Culture
- 9:30-10:45 a.m. Concurrent Sessions
 - A Collection of Short Performances
 - West African and Gullah Geechee Musical Examinations
- 10:55-11:40 a.m. Keynote: Sheila Walker
- 11:50 a.m.-12:20 p.m. Lightning Talks
- 12:20-1 p.m. Lunch (on your own)
- 1:05-2:35 p.m. Panel Discussions
 - Gullah Geechee Cultural Heritage Corridor Commission
 - African Diaspora Consortium
- 2:35-2:50 p.m. Lightning Talks
- 3-4:20 p.m. Film Festival and Session
 - Gullah Geechee Documentary Film Festival
 - Perseverance in the Record
- 4:30-5:45 p.m. Concurrent Sessions
 - African Diasporic Rebellion through the Visual Arts
 - The "Circle of Culture" Within the Pray's House
- 6-7 p.m. Spoken Word: Marcus Amaker
- 7:30-9 p.m. Reception: Taste of Gullah in Conway, Horry County Museum

Friday | Coastal Carolina University

- 7 a.m.-4:30 p.m. Registration
- 8:05-9:20 a.m. Concurrent Sessions
 - Transatlantic Memory
 - Latin American Expressions of Blackness
- 9:30-11 a.m. Panel Discussions
 - Through the Eyes of Gullah
 - Africa and Her Diaspora: Dialogue across the Atlantic

Friday (cont'd.) | Coastal Carolina University

11:05 a.m.-12:20 p.m. Concurrent Sessions

Afrofuturistic Imaginings

Transatlantic Identities

Toward an Understanding of Gullah Geechee Cultural Heritage

12:20-1 p.m. Lunch (on your own)

1:05-2:35 p.m. Concurrent Panels

Repatriation Event

Gullah Geechee Research in the Golden Isles, Georgia

2:40-3:10 p.m. Lightning Talks & Mini-Session

3:20-4:50 p.m. Film Festival and Sessions

Film: *The Language You Cry In*

Gullah Folklore and Rootwork

5-6:15 p.m. Concurrent Sessions

Reimagining the African Diaspora

Enslaved Traumas and Resistance

6:15-7:30 p.m. Dinner (on your own)

7:30-9:30 p.m. Musical Salute to Gullah

Saturday (Community Day) | Coastal Carolina University

7 a.m.-2p.m. Registration

8-9 a.m. Concurrent Sessions

Contemporary Issues Facing Gullah Geechee Communities

Talk yuh Talk: Language and Language Use Across Space and Time

9:50-11:05 a.m. Panel Discussion

Inheritance of the African Diaspora

11:10-12:25 p.m. Concurrent Sessions

Dying to Eat

Archeology and Tracing the African Diaspora

12:25-1:05 p.m. Lunch

1:10-2:15 p.m. Concurrent Sessions

Resolving Heirs' Property

African Drumming Workshop

2:20-3:35 p.m. Gullah Homecomings

4-5 p.m. Community Sing Services

SHUTTLE

Shuttle Service

A complimentary shuttle system will be available between the conference hotel (Hilton Garden Inn) and the conference locations. Please consult the schedule below.

Wednesday Evening, Brookgreen Gardens

Hilton Garden Inn to Brookgreen		Brookgreen to Hilton	
Depart	Arrive (est.)	Depart	Arrive (est.)
4 p.m.	5 p.m.	8:30 p.m.	9 p.m.

Thursday-Friday, March 7-8

Hilton to Coastal Carolina University		Coastal Carolina University to Hilton	
Depart	Arrive (est.)	Depart	Arrive (est.)
7 a.m.	7:30 a.m.		
9:00 a.m.	9:30 a.m.		
11:00 a.m.	11:30 a.m.	3 p.m.	3:30 p.m.
		6 p.m.	6:30 p.m.
6:30 p.m.	7 p.m.		

Saturday, March 9

Hilton to CCU		CCU to Hilton	
Depart	Arrive (est.)	Depart	Arrive (est.)
7 a.m.	7:30 a.m.		
9:00 a.m.	9:30 a.m.		
11:00 a.m.	11:30 a.m.	3 p.m.	3:30 p.m.
		5 p.m.	5:30 p.m.

Thursday Evening, Taste of Horry

CCU to Horry County Museum		Horry County Museum to Hilton	
Depart	Arrive (est.)	Depart	Arrive (est.)
7:15 p.m.	7:30 p.m.	9 p.m.	9:30 p.m.

Friday Evening, Salute to Gullah

CCU to Hilton	
Depart	Arrive (est.)
9:30 p.m.	10 p.m.

Conference Location Map

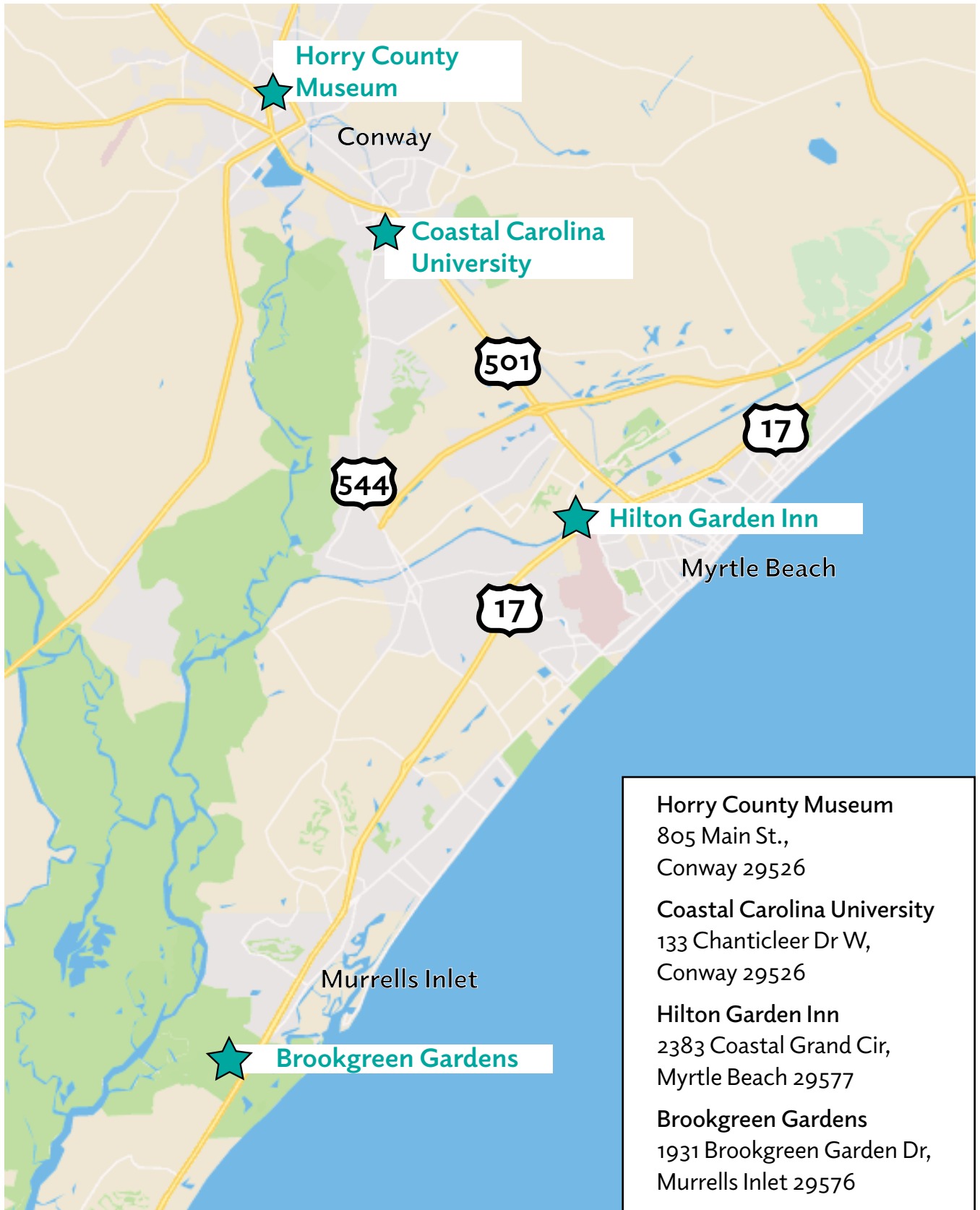

Coastal Carolina University | Campus Map

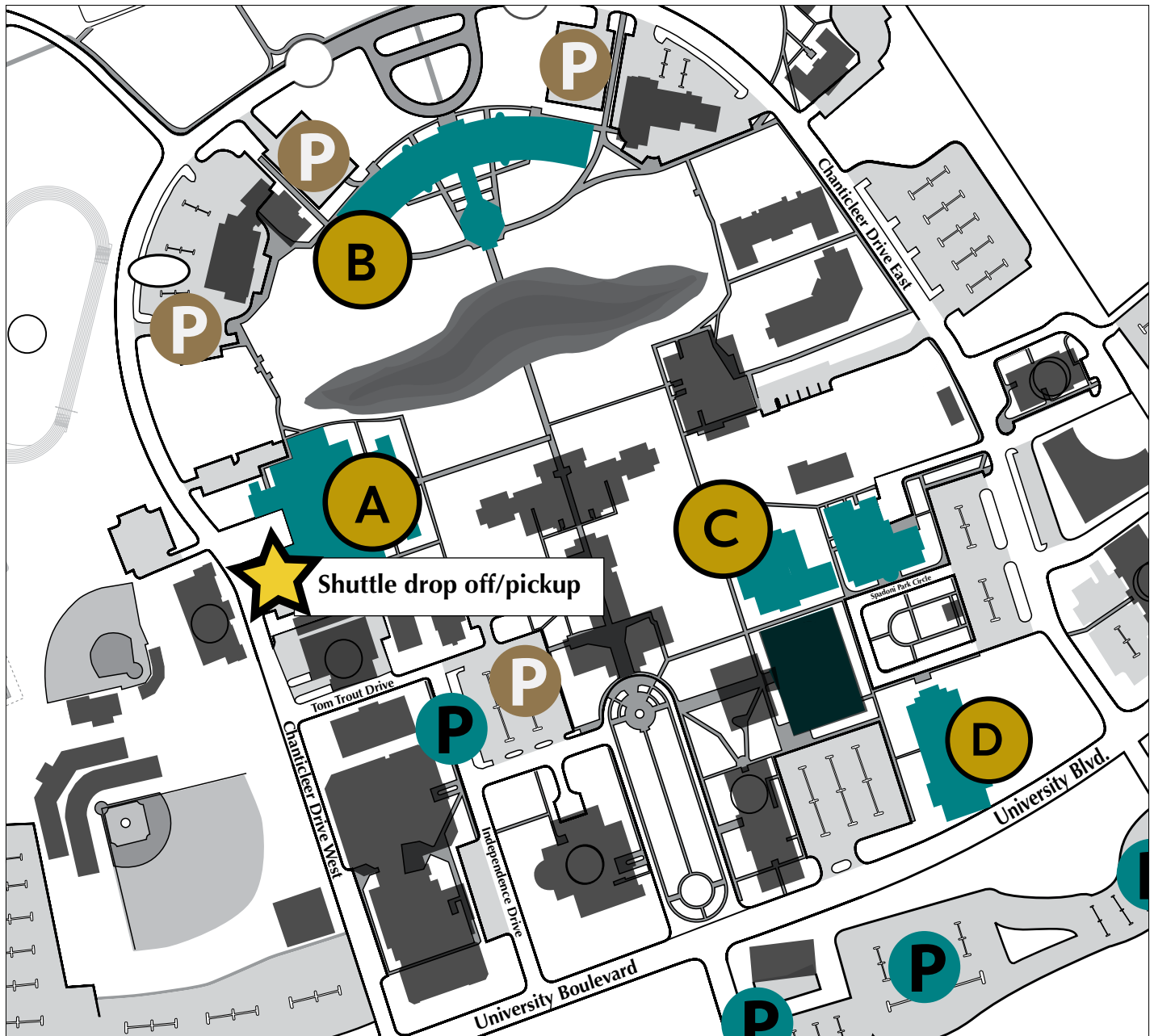

A. EHFA | Thomas W. and Robin W. Edwards
College of Humanities and Fine Arts
133 Chanticleer Dr. W, Conway 29526

B. Wall | E. Craig Wall Sr. College of Business
Administration
119 Chanticleer Drive E., Conway 29526

C. Lib Jackson Student Union
100 Spadoni Park Circle, Conway 29526

D. Wheelwright Auditorium
108 Spadoni Park Circle, Conway 29526

Coastal Carolina University | Parking

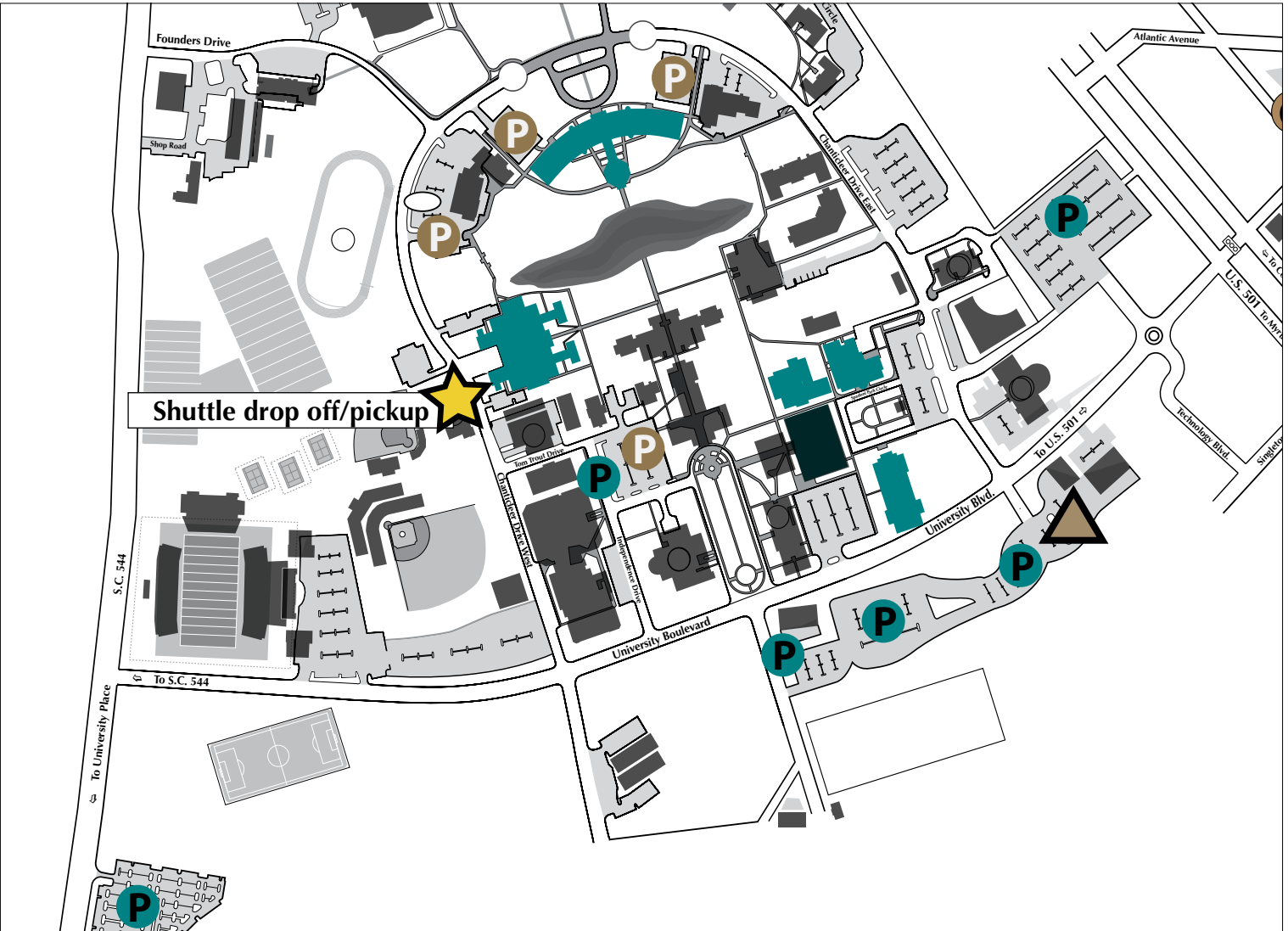

P : Limited Parking Available

P : Parking after 4:30 p.m.

Shuttle Stop

A complimentary conference shuttle will be running between the Hilton Garden Inn and Coastal Carolina University from Thursday to Saturday. The shuttle will drop off and pick up participants at the yellow star.

Handicap Parking

Accessible parking spots are available in gated lots for those that hold a disability placard. Register your vehicle at Public Safety (see the bronze triangle).

Conference Parking

A limited number of visitor spots are available on campus, marked with the Teal “P” on the map above.

Edwards Building (EHFA) | First Floor

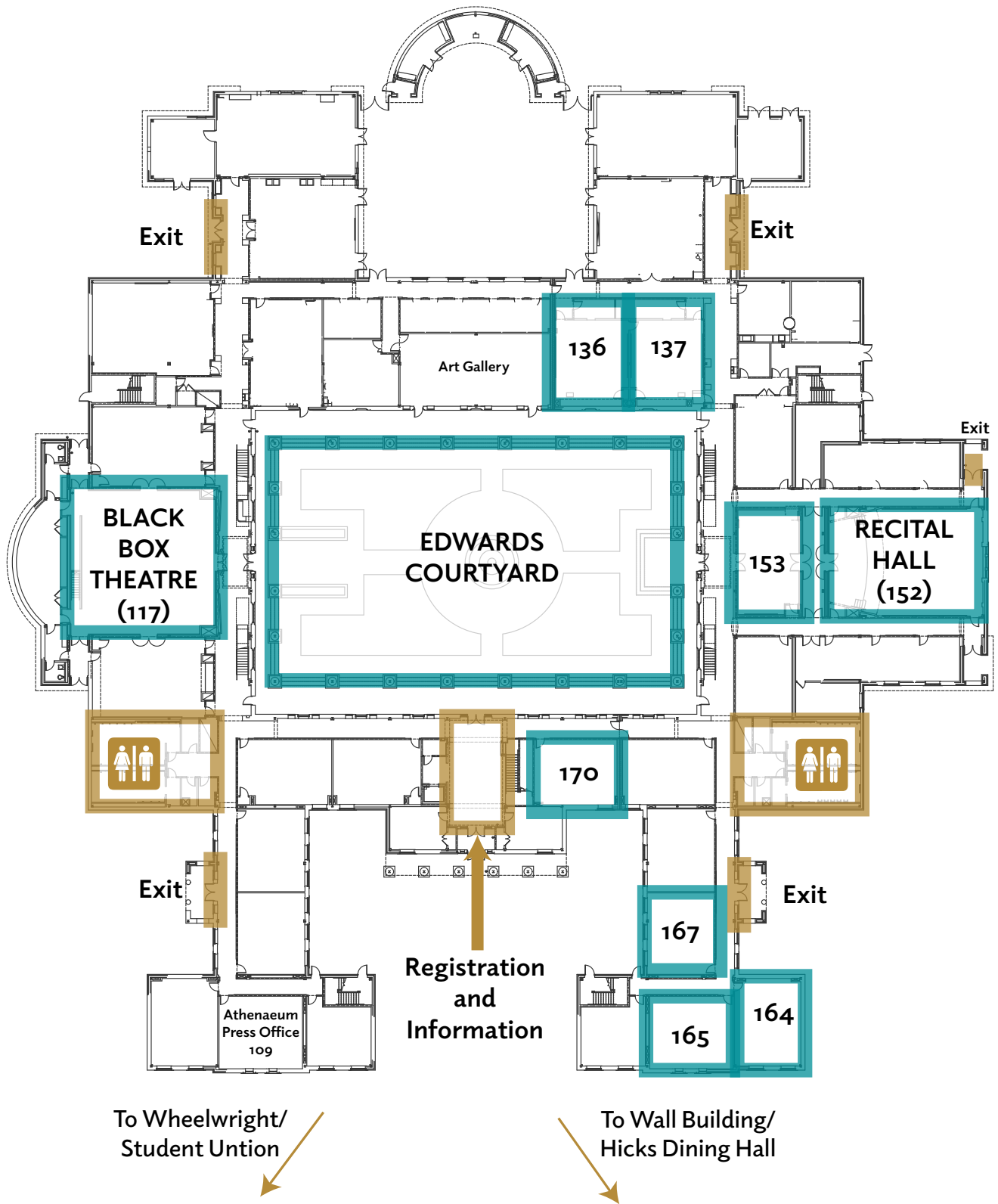

Edwards Building (EHFA) | Second Floor

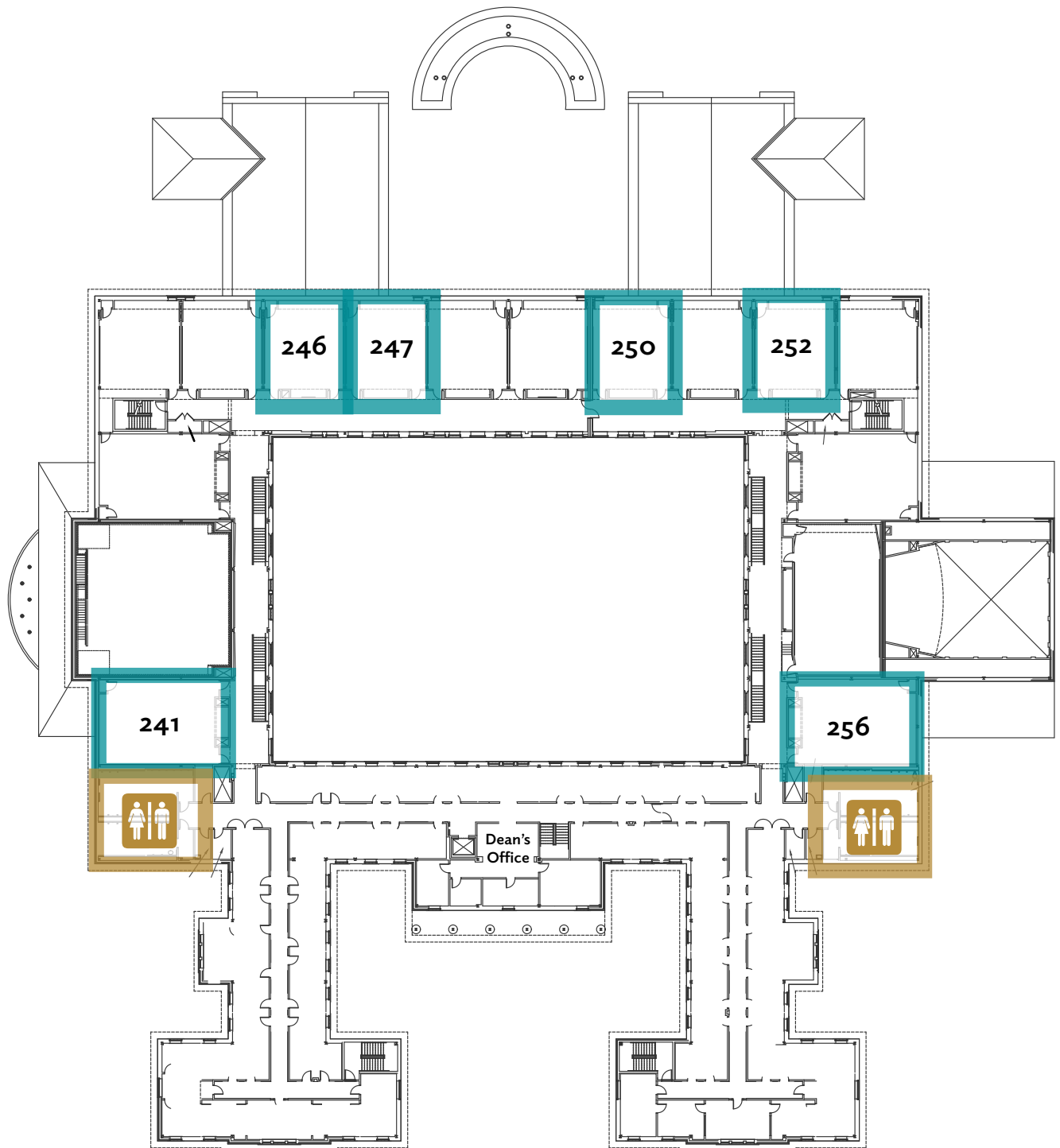

Full Schedule

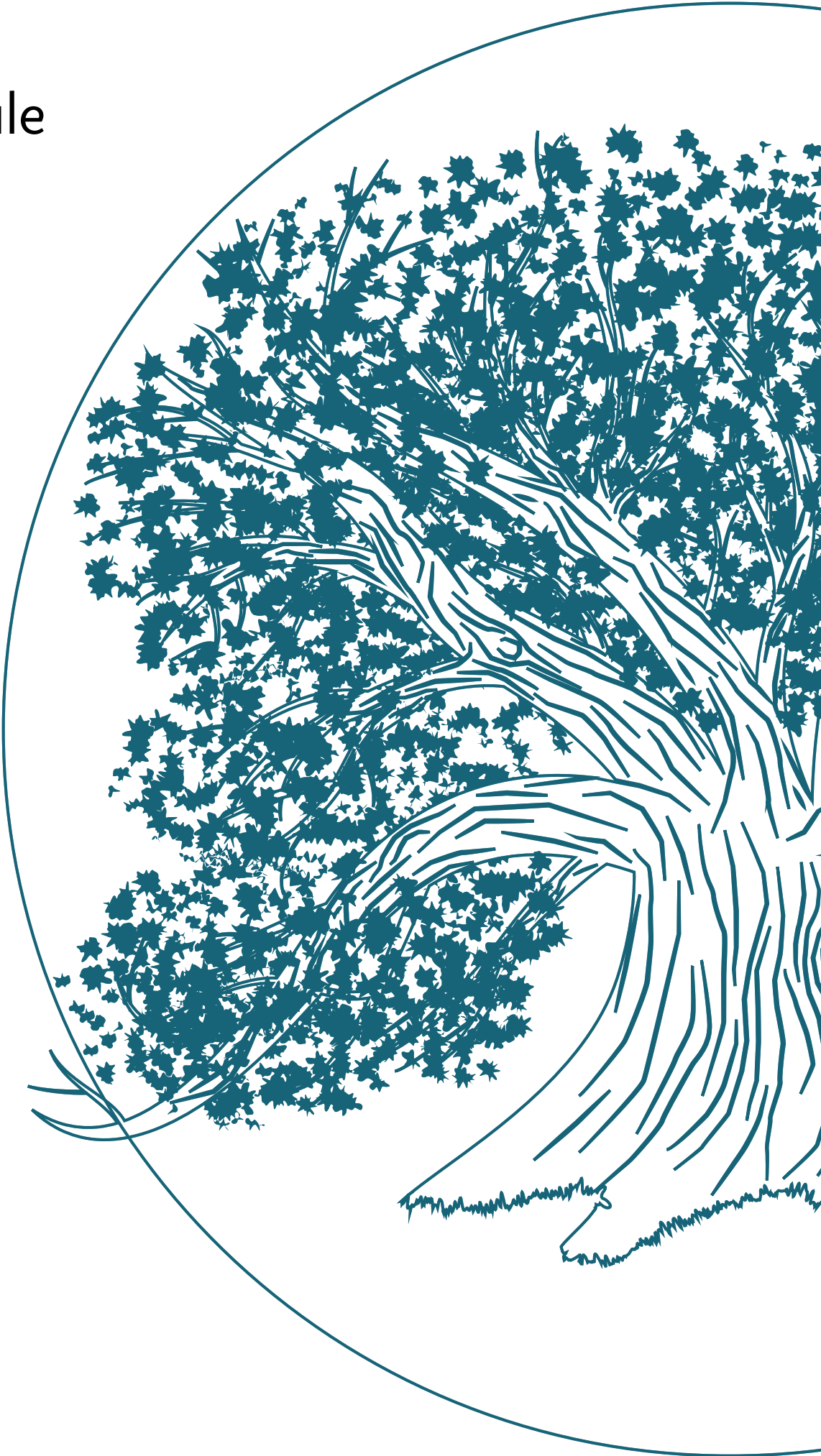



Wednesday

BROOKGREEN GARDENS

5-5:30 p.m. VISIT BROOKGREEN GARDENS

Enjoy the early evening light by visiting the “Frum We Own’t Yeye” (Learning Lab One) and “Gullah Geechee Gaardin” (Lowcountry Center Gardens). A docent will be available in the Learning Lab One, and Ron Daise will offer commentary while guests visit the Gullah Geechee Gaardin.

5:30 p.m. WELCOME AND PRESENTATION

Welcome

Page Kiniry (President and CEO, Brookgreen Gardens)

O, Freedom Ova Me! Past, Present and Future

Ron Daise (VP for Creative Education, Brookgreen Gardens)

6-7 p.m. LECTURE AND PERFORMANCE



Marlena Smalls

Smalls founded The Hallelujah Singers in 1990 to preserve the Gullah culture of the South Carolina Sea Islands. She is a sacred music vocalist, also singing gospel, contemporary, jazz and blues. Her programs for schools, reunion and meeting groups incorporate lecture, music and Gullah storytelling. Inducted into the South Carolina Black Hall of Fame in 2004, Smalls has performed for the Queen of England and many U.S. and international dignitaries. She has worked with film producer Joel Silver and Academy Award-winners Tom Hanks, Demi Moore and Glenn Close. In addition to many productions for PBS, SCETV and GPTC, she is known to international audiences as Bubba’s mom in the Academy Award-winning motion picture *Forrest Gump*.

7-8:30 p.m. RECEPTION AT LOWCOUNTRY CENTER



Thursday

COASTAL CAROLINA UNIVERSITY

Green denotes invited speaker or Gullah Geechee Heritage Corridor Member (GGCHC)
EHFA = Edwards Humanities and Fine Arts Building

7-4:30 p.m. **REGISTRATION | EHFA Lobby**

7-8 a.m. **PASTRIES AND COFFEE | EHFA 164**

8:05-9:20 a.m. **CONCURRENT SESSIONS**

EHFA 137 | Partial Truths: Toward a Better Understanding of Invisible Institutions Present in Gullah Culture

Invisible Institutions within and among Gullah Communities
Veronica Gerald (Coastal Carolina University)

The Hidden Story of John William Bolts: Teacher and Politician
Valerie McLaurin (Coastal Carolina University)

The Water: Examining the Meanings of Saltwater in the Making of Gullah Pasts, Presents, and Futures
Krystal A. Smalls (University of Illinois Urbana-Champaign)

Recital Hall (EHFA 152) | Reinterpretations of Gullah Geechee Culture

Wha Dah Putah Say Bout We?: How Digital Media Preserves and Reinvents Gullah-Geechee Culture
Arlecia D. Simmons (Claflin University)

Reconstruction 360 | Module One: Forty Acres and a Mule
Betsy Newman (South Carolina Educational Television)

9:30-10:45 a.m. **CONCURRENT SESSIONS**

Black Box Theatre (EHFA 117) | A Collection of Short Performances

Chair: Gwendolyn Schwinke (Coastal Carolina University)

EHFA 170 | West African and Gullah Geechee Musical Examinations

African American Spirituals: Inspirational Voices Old and New
Gregory Gardner (Norfolk State University)

“Gullah is My Ministry”: Music and Religion-as-Policy among Gullah Geechees
Douglas Peach (Indiana University-Bloomington)

An Examination of the Fanti Spirituals Found in Nicholas Ballanta’s Manuscripts
Dyke Kiel (Cottey College)

10:55-11:40 a.m. **KEYNOTE**

Recital Hall



Sheila Walker

A cultural anthropologist and filmmaker, Walker is executive director of Afrodiaspora, Inc., a nonprofit organization that develops documentary films and educational materials about the global African Diaspora. Her most recent works are the documentary *Slave Routes: A Global Vision*, produced for the UNESCO Slave Route Project, and an edited book featuring articles by Afrodescendants from South America.

11:50 a.m.–12:20 p.m. LIGHTNING TALKS**EHFA 137**

Stretched and Limited: The Role of Organizational Partnerships on Somali Refugees' Integration Experience
Elizabeth Burdette Roberts (College of Charleston)

We Understand Ayo: Preserving our Past, Shaping our Future
Nadine Marchena Kean (Independent Scholar)

Recital Hall

Buried in Plain Sight: Atlanta Connections to Lowcountry Aesthetic and Spatial Orientation in Georgia Coastal/Sea Islands
Tiffany Harris (University of Illinois at Urbana-Champaign)

Reinventing Erzulie's Past for Literature's Future
Nia Dickens (Richard Hugo House)

12:20–1 p.m. LUNCH**1:05–2:35 p.m. PANEL DISCUSSIONS****Black Box Theatre | Gullah Geechee Cultural Heritage Corridor Commission**

Chair: *Heather Hodges (GGCHC)*

Executive Director Heather Hodges will lead a discussion on the past, present and future of the Corridor.

Recital Hall | African Diaspora Consortium: Utilizing Research and Best Practices to Enhance Educational Outcomes Across the African Diaspora

Chair: *Rhonesha Blaché (Teachers College, Columbia University)*

Educating Across the Diaspora: The Development and Implementation of a Seminal Advanced Placement Course with African Diaspora Content
Nafees Khan (Clemson University)

The African Diaspora Globalization Student Exchange (ADGSE): The Arts as Cross-Culture Interconnection and Social Justice Leadership
Kim N. Archung (Global Student Affairs)

Empower Over Power: Students' Engagement with Inequality and Social Justice and Perceptions of Their Social Environment
Shani Nakhid-Schuster (Teachers College, Columbia University)

An Indigenous and Spiritual Lens on Culturally Responsive Education
Nakeeba Wauchope (New York University-Steinhardt)

2:35–2:50 p.m. LIGHTNING TALKS**EHFA 250**

Correlations of Human Genomic Diversity and Oral Microbiome Diversity in African-American Groups
Esohe Irabor (Howard University)

EHFA 252

Identifying Genetic and Bio-Cultural Associations to Cardiovascular Disease amongst the Gullah Geechee and Affiliated Groups
Jennifer Caldwell (Howard University)

3-4:20 p.m. FILM FESTIVAL AND SESSION

**Movie Theatre (Lib Jackson Student Union) | Gullah Geechee Documentary
 Film Festival**

Chair: *Heather Hodges (GGCHC)*

**Recital Hall | Perseverance in the Record: Archaeological Examples of Institutional
 Continuity from Guinea to South Carolina**

Chair: *Andrew Agha*

Spiritual Spaces Within the Diaspora: Identifying Shrines at Dean Hall Plantation, Berkeley County, South Carolina

Andrew Agha (Coastal Carolina University, University of South Carolina-Columbia)

Clay Bonds: Contextualizing Locally-Made Colonowares into the Atlantic World

Nicole Isenbarger (Coastal Carolina University)

Marrying for Money: How Transnational Family Alliances Contributed to the Proliferation of the “Illicit” Slave Trade in 19th Century Guinea

Kelly Goldberg (University of South Carolina-Columbia)

4:30-5:45 p.m. CONCURRENT SESSIONS

EHFA 136 | African Diasporic Rebellion through the Visual Arts

Codes to Freedom: Gullah to Afro-Colombian

Ellen Zisholtz (Center for Creative Partnerships)

Elizabeth Charlton (South Carolina State University, Oxford University, England)

The Code: Visual Arts As Resistance To Enslavement

Anne Bouie (Art Historian)

The Resurgence of African Printed Textiles and Fashion as an Expression of Resilience and Empowerment in African American Artistry

Alice R. Burmeister (Winthrop University)

EHFA 137 | The “Circle of Culture” Within the Pray’s House

Gullah Voices and The Ties That Bind

Robert W. Stephens (University of Connecticut)

Praying, Singing and Catching Sense: Praise House Traditions in Gullah Geechee Communities

Victoria Smalls (GGCHC)

When Hip-Hop Meets Ring-Shout

Anwar Uhuru (Harris Stowe State University)

6-7 p.m. SPOKEN WORD: Marcus Amaker**Johnson Auditorium (Wall Building)****Marcus Amaker**

Charleston's first poet laureate and award-winning graphic designer, Marcus Amaker gives a spoken word reading. Amaker has published seven books of poetry and has been featured on PBS Newshour, TEDxCharleston, *Huffington Post*, the A&E Network, *Charleston Magazine* and *The Post and Courier*. As a musician, Amaker has created more than 30 electronic music albums, and his latest project, *empath*, is a collaboration with Grammy-nominated producer Quentin E. Baxter.

7:30-9 p.m. TASTE OF GULLAH IN CONWAY**Horry County Museum (Historic Conway)**

Join Coastal Carolina University's Athenaeum Press to experience tastes from Gullah chefs of Horry County. This reception will feature chef Margaret Harriott of Ms. Margaret's Soul Food and independent caterer Deawyne Beaty.

The Athenaeum Press has been working with local communities to document the hidden histories of South Carolina since 2013. Topics range from Gullah spirituals to pirates to African American soldiers during World War II. The Press projects (both finished and in-process) will be displayed alongside the museum's permanent collections. The Gullah Geechee Cultural Heritage Corridor will also provide information about their initiatives and resources throughout the region.

A shuttle will be leaving CCU for the museum at 7 p.m.

The shuttle will depart from the museum to the conference hotel at 9 p.m.



Friday

COASTAL CAROLINA UNIVERSITY

7 a.m. - 4:30 p.m. **REGISTRATION | EHFA Lobby**

7-8 a.m. **COFFEE AND PASTRIES | EHFA 164**

8:05-9:20 a.m. **CONCURRENT SESSIONS**

EHFA 241 | Transatlantic Memory

In the Jaws of the Atlantic Slave Trade: A Biography of São Jorge da Mina (Elmina Slave Castle)

Edmund Abaka (University of Miami)

Marlon James's *The Book of Night Women: Personal and Political Awakenings of a Slave Woman*

Matthew L. Miller (University of South Carolina-Aiken)

Portrait of the Enslaved African as the Stripped Migrant in Edouard Glissant's Poetics

Mamadou Moustapha Ly (University of Denver)

EHFA 153 | Latin American Expressions of Blackness

Pan-African Feminist Praxis and Venezuela's Bolivarian Revolution

Layla Brown-Vincent (University of Massachusetts-Boston)

U.S. Jim Crow Empire: Policing Puerto Rican Citizenship and Women of Color's Behavior during the Progressive Era

D.J. Polite (University of South Carolina-Columbia)

Warrior Women: The Transformative Culture of Cloth in Bahia

Precious D. Lovell (North Carolina State University)

9:30-11 a.m. **PANEL DISCUSSIONS**

EHFA 153 | Through the Eyes of Gullah: Memory and the Aesthetics of Gullah Culture

Chairs: Corrie Claiborne (Morehouse College)

Samuel Livingston (Morehouse College)

Recital Hall (EHFA 152) | Africa and Her Diaspora: Dialogue across the Atlantic

Chair: Gorgui Dieng (Cheikh Anta Diop University)

Cross-Influences between African and African American Literatures

Gorgui Dieng

Africa and her Diaspora: Being, Be-Coming and Be-Longing

Saliou Dione (Cheikh Anta Diop University)

Negritude: a Networking Re-reading of Diasporic Resistance

Abib Sene (Cheikh Anta Diop University)

New African Women's Voices Talking to/about the Diaspora Echoing Diasporic Backgrounds

Abdou Ngom (Cheikh Anta Diop University)

Constructing Decolonial Literary Monuments: African Diaspora Authors towards the Griotic Language of Great Communications

Oumar Diogoye Diouf (Cheikh Anta Diop University)

11:05 a.m.-12:20 p.m. **CONCURRENT SESSIONS****EHFA 256 | Afrofuturistic Imaginings of the Transatlantic Identities African Diaspora**

“Cotch de Laarnin”: An Exploration of Gullah Geechee Folks as Blueprints for Afrofuturist
Sara Makeba Daise (Cultural History Interpreter)

Black Matter: An Installation Based on Black Hole Physics, American Folklore, Afrofuturism
 and Imagination
Jessica Scott-Felder (Wofford College)

“Curtain[s] of Fog”: Temporal Backscattering and Resistance in Nalo Hopkinson’s Novels
Hannah Hjerpe-Schroeder (Emory University)

EHFA 250 | Transatlantic Identities

Contemplations on Dutch Caribbean Consciousness Poetics: An Examination of Oswin
 “Chin” Behilia’s Lyrical Ideologies and Hemayel Martina’s & Levi Silvanie’s “Ami Ta Kòrsou”
Florencia V. Cornet (University of South Carolina-Columbia)

Racial Identity in the Colonial Classroom
Rhonda Ferreira Habersham (Independent Scholar)

Narratives of Expressive and Aesthetic Art and the Development of Civil Society in the
 Caribbean
Kim Williams-Pulfer (Indiana University)

Recital Hall | Toward an Understanding of Gullah Geechee Cultural Heritage

The Essence of Gullah Geechee Cultural Heritage: A Steady Force in Coastal South Carolina
 Pluralism
Emory Campbell (Gullah Heritage Consulting Services, GGCHC)

Catching Sense, Collective Memory, and Black People: Notes on the Terms Geechee and
 Gullah
J. Vern Cromartie (Contra Costa College)

The Gullah Language in Relation to Its Sisters and Cousins
David Frank (SIL International, GGCHC)

12:20-1 p.m. **LUNCH (ON YOUR OWN)**1:05-2:35 p.m. **REPATRIATION EVENT AND PANEL****Recital Hall | Repatriation Event**

In preparation for their collaborative National Archives grant, the Association for Cultural
 Equity, the Library of Congress and Coastal Carolina Univeristy will introduce, and discuss
 the importance of, the Alan Lomax Recordings from Murrells Inlet, S.C.

Jorge Arévalo Mateus (Association for Cultural Equity)
Anna Wood Lomax (Association for Cultural Equity)
Todd Harvey (Library of Congress)
Kimberley Bugg (Library of Congress)

EHFA 153 | Gullah Geechee Research in the Golden Isles, GA

Patrick J. Holladay (Troy University)

Melanie R. Pavich (Penfield College of Mercer University)

Chad T. Keller (Georgia State University)

Tyler E. Bagwell (College of Coastal Georgia)

2:40-3:10 p.m. LIGHTNING TALKS & MINI-SESSION**Recital Hall | Lightning Talks**

PTSD in Urban Neighborhoods: An Analysis of J. Cole's KOD album

Bre'Anie Sanders (University of North Carolina-Greensboro)

Jolanda Kendall (University of North Carolina-Greensboro)

A Look at the Resilience of Black Women in the Face of Love,
Pain, and Racism

Lora Mitchell (Independent Scholar)

EHFA 247 | Mini-Session

“Our Story” Passing Stories from One Generation to the Next, Using the Art of Dollmaking

Zenobia G. Harper (Independent Scholar)

3:20-4:50 p.m. FILM FESTIVAL AND SESSION**Johnson Auditorium (Wall) | Film: *The Language You Cry In: The Story of a Gullah Song in the Mende Language of Sierra Leone***

Cynthia Schmidt (Creighton University)

Joe Opala (Independent Scholar)

Herb Frazier (Magnolia Plantation and Gardens, GGCHC)

EHFA 246 | Gullah Folklore and Rootwork

Making Gullah: Reflections on Finding Gullah Folk in the American Imagination

Melissa Cooper (Rutgers University)

Imagining Lizzie: The Storied Land and Table—Rooted in Diaspora Memory and Belonging

Portia Cobb (University of Wisconsin-Milwaukee)

Scott Alves Barton (Culinary Historian)

5-6:15 p.m. CONCURRENT SESSIONS**EHFA 136 | Reimagining the African Diaspora**

Comparative Ethnomedicine in the America-Sierra Leone Nexus

Cyrus MacFoy (University of Maryland University College)

“Re-Imagining Ancient African-Diaspora Folklore for Contemporary Children”

Marjuan Canady (Canady Foundation for the Arts)

“Re-member: The Importance of Ancestral Connections, Resistance, and Divine Destiny to African Peoples”

Simeon Daise (Independent Scholar)

EHFA 137 | Enslaved Traumas and Resistance

Combee': Harriet Tubman, the Combahee River Raid, and the Civil War Transformation of the Gullah Geechee

Edda Fields-Black (Carnegie Mellon University)

Weeping Time: Memory and the Largest Slave Auction in History

Anne Bailey (Binghamton University)

"Servants Be Obedient to Your Masters:" Slavery, Catechisms, and Christian Religious Instruction in the Antebellum South

Tammy Byron (Dalton State College)

6:15-7:30 p.m. DINNER (ON YOUR OWN)

7:30-9 p.m. MUSICAL SALUTE TO GULLAH

This event is complimentary to all conference participants. Join us for the Geechee Gullah Ring Shouters, Ron and Natalie Daise, and Aunt Pearlle Sue as they bring iconic Gullah performances to the stage.



Geechee Gullah Ring Shouters

The Geechee Gullah Ring Shouters, all descendants of African slaves, perform one of the oldest surviving African artistic traditions. The group performs nationally, making history in Washington, D.C., in 2011 by setting the Guinness World Record for leading the largest recorded ring shout.



Aunt Pearlle Sue

Aunt Pearlle Sue is the creation of Anita Singleton-Prather, a native of the Sea Islands in Beaufort County, S.C. Based on her grandmother, Aunt Pearlle Sue's character has entertained audiences with Gullah-inspired folktales for more than a decade and created the PBS special *Circle Unbroken—A Gullah Journey from Africa to America*.



Ron and Natalie Daise

Ron Daise, vice president for creative education at Brookgreen Gardens and a native of St. Helena Island, and his wife Natalie Daise, a storyteller and artist, are writers, actors, educators and internationally renowned television performers known for their roles on Nickelodeon's award-winning *Gullah Gullah Island*.

A shuttle will be leaving Coastal at 9:30 p.m. to the conference hotel.



Saturday

COASTAL CAROLINA UNIVERSITY

7 a.m.-2 p.m. **REGISTRATION | EHFA Lobby**

7-8 a.m. **COFFEE AND PASTRIES | EHFA 164**

8-9:45 a.m. **CONCURRENT SESSIONS**

EHFA 136 | Current Issues Facing Gullah Geechee Communities

Women, Freedom, and Coherence Among Lowcountry Heirs' Property Tenure
Robin Throne (Northcentral University)

Place Based Methodology of Black Rural Healthcare Utilization: A Case Study of the Gullah-Geechee of McIntosh County, Georgia
Roman Johnson (University of Alabama-Birmingham)

Babylon is Falling: The State of the Art of Sweetgrass Basketry
Dale Rosengarten (College of Charleston)
Nakia Wigfall (Sweetgrass Gullah Connection)

EHFA 137 | Talk yuh talk: Language and Language Use Across Space and Time

Chair: Alison McLetchie, Claflin University

The Poetess of Protest: Exploring the Poetics of Nina Simone's Protest Music
Heather Buffington-Anderson (Claflin University)

Language and Identity in Contemporary Creole Contexts: A Comparative Look at Gullah/Geechee and Nigerian Pidgin
Jessica R. Berry (South Carolina State University)

Christine I. Ofulue (National Open University of Nigeria)
Tracey L. Weldon (University of South Carolina-Columbia)

The Influence of Patois in Trinidad and Tobago: The Case of Paramin
Claudette Sinnette (University of Trinidad and Tobago)

9:50-11:05 a.m. **PANEL DISCUSSION**

EHFA 165 | Inheritance of the African Diaspora

Schooled by the Elders: Writing of The Ghosts are Dying
Althea Natalga Sumpter (Independent Scholar, GGCHC)

Scenes and Stories from the Diaspora: Perspectives from Saint Lucia and South Carolina
Elizabeth Serieux (University of South Carolina-Beaufort)
Najmah Thomas (University of South Carolina-Beaufort)
Winston Phulgence (University of York)

EHFA 136 | Revisiting Black Women Writers of the Gullah Geechee Renaissance

Chair: Nicole Morris Johnson (California State University-Northridge)

11:10 a.m.-12:25 p.m. **CONCURRENT SESSIONS**

EHFA 167 | Dying to Eat

Amy Edmunds (Coastal Carolina University)
Veronica Gerald (Coastal Carolina University)

EHFA 136 | Archeology and Tracing the African Diaspora: Current Work in the Lowcountry and Its Implications

Chair: David Palmer (Coastal Carolina University)

Archaeological Investigations of Captive African Life at the Brookgreen Rice Plantation
David Palmer

What Did They Eat?: Findings and Questions on Pre- and Post-Emancipation Foodways on James Island, South Carolina
Brandy Joy (University of South Carolina-Columbia)

Material Expressions of Independence and Community Among the Geechee of Georgia
Brad Botwick (New South Associates)

12:25-1:05 p.m. LUNCH

Cheryl Adamson (CHOPS Produce Community Cannery)

1:10-2:15 p.m. CONCURRENT SESSIONS

EHFA 136 | Resolving Heirs' Property and Sustainably Managing Land

Jennie Stephens (Center for Heirs' Property Preservation)

Recital Hall (EHFA 152) | African Drumming Workshop

Roger Johansen (Coastal Carolina University)

2:20-3:35 p.m. SESSION

EHFA 136 | Gullah Homecomings

Barbados/Caribbean and the Carolinas/U.S. Interconnectedness
Rhoda Green (Barbados Honorary Consultant to South Carolina)

Reconnecting Beyond the Fanfare: Tracing Sierra Leonean and Gullah Linkages in the U.S. and the Caribbean
Amadu Massally (Senior Consultant on Diaspora and Governance)

Gullah Seminoles
Joseph Opala (Independent Scholar)

4-5 p.m. COMMUNITY FORUM

Wheelwright Auditorium

Devotional Service

Community Leaders' Forum

5 p.m. CLOSE OF CONFERENCE

Campus Dining

Coffee/Bagels : Starbucks Kimbel Library; Einstein's Bagels Brittain Hall

CINO Grill (Chick-fil-A; Sushi; Salad Bar; Ramen; Smoothies) Lib Jackson Student Union

Road Rooster Asian Food Truck Prince Lawn

Restaurants Close to University *(Less than 2 miles from Coastal Carolina University)*

Rotelli's 2089 US-501 (843) 349-6700

Italian Staples and Pizza (\$\$)

Moe's Southwest Grill 201 Graduate Rd. (843) 347-3111

National Chain for Southwest Fare (\$)

Tropical Smoothie Café 201 Graduate Rd. Unit 103 (843) 234-5670

Chain for Smoothies and Sandwiches (\$)

801 Billiards & Bowling 2001 Hwy 501 E (843) 347-9888

Burgers, Pizzas and Craft Beer with Games (\$\$)

Coffee Nerd 182 Waccamaw Medical Part Ct (843) 347-9393

Coffee and Sandwiches (Breakfast/Lunch) (\$)

El Patio 2394 US 501 (843) 347-6984

Mexican Restaurant with Bar (\$-\$)

Conway Restaurants *(Approximately 5 miles from Coastal Carolina University)*

Ms. Margaret's Soul Food 501 Church St (843) 438-8092

Gullah and Soul Food Casual Kitchen (\$\$)

Rivertown Bistro 1111 3rd Ave. (843) 248-3733

French-Southern Restaurant (\$\$\$)

The Trestle Bakery 322 Main St (843) 488-2069

Breakfast and Lunch Cafe (\$)

Crooked Oak Tavern 328 Laurel St (843) 488-0007

Farm-to-Table Steaks and Rotating Specials (\$\$\$)

The Crafty Rooster 1125 3rd Ave (843) 438-8330

Craft Beer Bar and Hamburgers (\$)

Pickled Cucumber 1127 3rd Ave. (843) 915-0019

Meat and Three Breakfast/Lunch (\$)

Ocean Fish Market 302 Kinston St (843) 248-4334

Tiny Diner with Fresh Fried Fish and Seafood Market (\$)

Donzelle's Restaurant 1703 Main St (843) 248-2301
Fried Chicken and Southern Diner (\$)

Tacqueria Guanajuato 1705 Park View Rd. (843) 438-8568
Authentic Tacqueria (\$)

Saigon Bistro 1600 Main St. (843) 488-3330
Vietnamese and Bahn Mi (\$)

Main Street Jamaican 330 Main St. (843) 438-8568
Casual Jamaican Restaurant (\$\$)

The Grumpy Monk 4545 US-501 (843) 236-5888
Craft Beer Restaurant and Sushi (\$\$)

Jo Hibachi 300 Elm St. (843) 488-3999
Rice and Noodle Stir-Fry (\$\$)

Coppers Restaurant 201 Laurel St. (843) 488-0783
Traditional American Lunch Buffet and Restaurant (\$\$)

Groucho's Deli 219 Laurel St. (843) 488-2911
National Chain for Sandwiches (\$)

Joey Doggs Conway 5 Laurel St. (843) 488-5639
Hot dogs and Fries (\$)

Restaurants Near Hilton Garden Inn *(Around the Coastal Grand Circle)*

Sticky Fingers 2461 Coastal Grand Cir. (843) 839-7427
Fried Chicken and BBQ (\$\$)

Abuelo's Mexican Food Embassy 740 Coastal Grand Cir. (843) 448-5533
Mexican Chain Restaurant and Bar (\$\$)

Maggi Di's 385 Seaboard St. (843) 213-1041
Italian Restaurant (\$\$)

Cracker Barrel Old Country Store 1208 N Retail Ct. (843) 916-8241
Chain for Country Staples (\$)

Red Robin 1218 N Retail Ct. (843) 626-2920
Chain for Burgers and Beer (\$\$)

Red Lobster 1230 N Retail Ct. (843) 445-9786
Chain for Seafood (\$\$)