

KIMBEL LIBRARY *and* BRYAN INFORMATION COMMONS

FIRST FLOOR

Coastal Carolina University
Kimbel Library and Bryan
Information Commons
376 University Blvd.
Conway, SC 29526

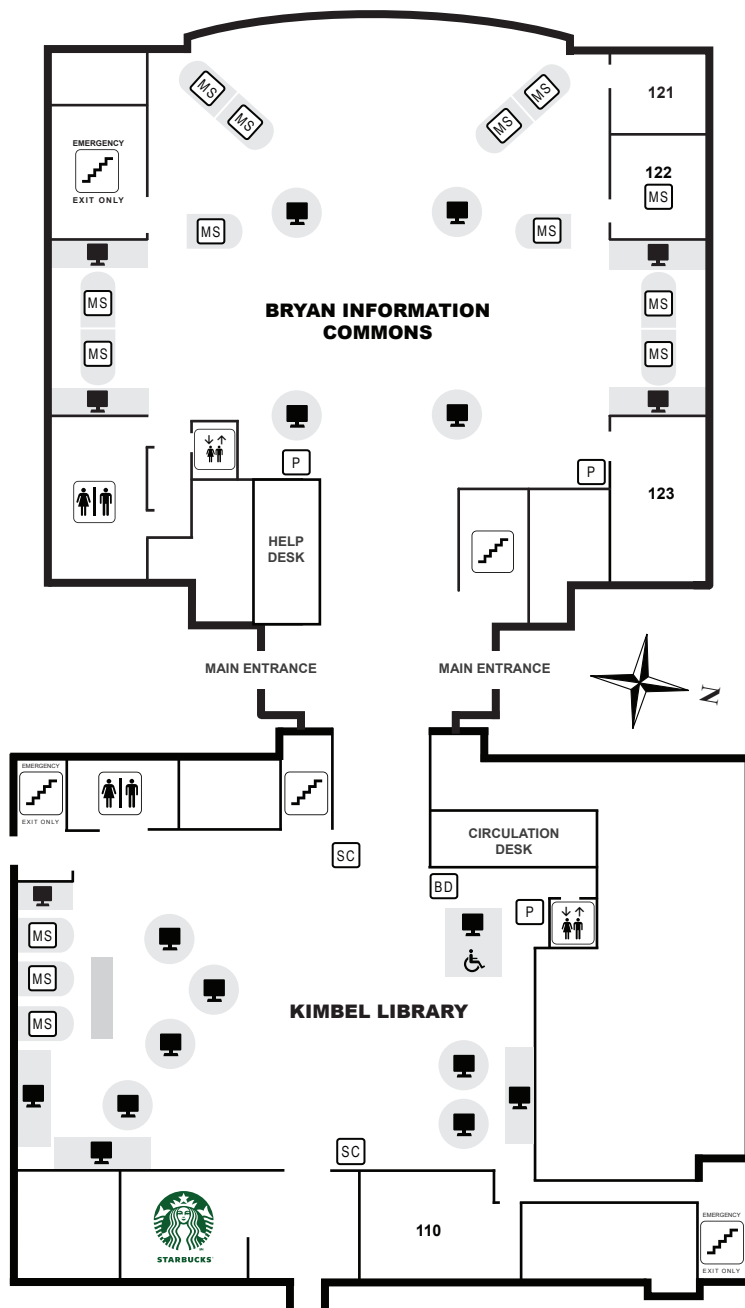

Reference: 843-349-2414
Circulation: 843-349-2400

coastal.edu/library
asklib@coastal.edu
TXT/SMS: 843-376-5468

MAP KEY

MS	Mediascape
SC	Self Checkout Station
BD	Book Drop/Return
P	Printing Station
V	Vending Machines
Computer Workstation Icon	Computer Workstations
Restroom Icon	Restrooms
Stairs Icon	Stairs
Elevator Icon	Elevator
Library Stacks Icon	Library Stacks

ROOM DIRECTORY

110	Instruction Room
121	Group Study Room
122	Group Study Room
123	Presentation Room

KIMBEL LIBRARY *and* BRYAN INFORMATION COMMONS

SECOND FLOOR

Coastal Carolina University
Kimbel Library and Bryan
Information Commons
376 University Blvd.
Conway, SC 29526

Reference: 843-349-2414
Circulation: 843-349-2400

coastal.edu/library
asklib@coastal.edu
TXT/SMS: 843-376-5468

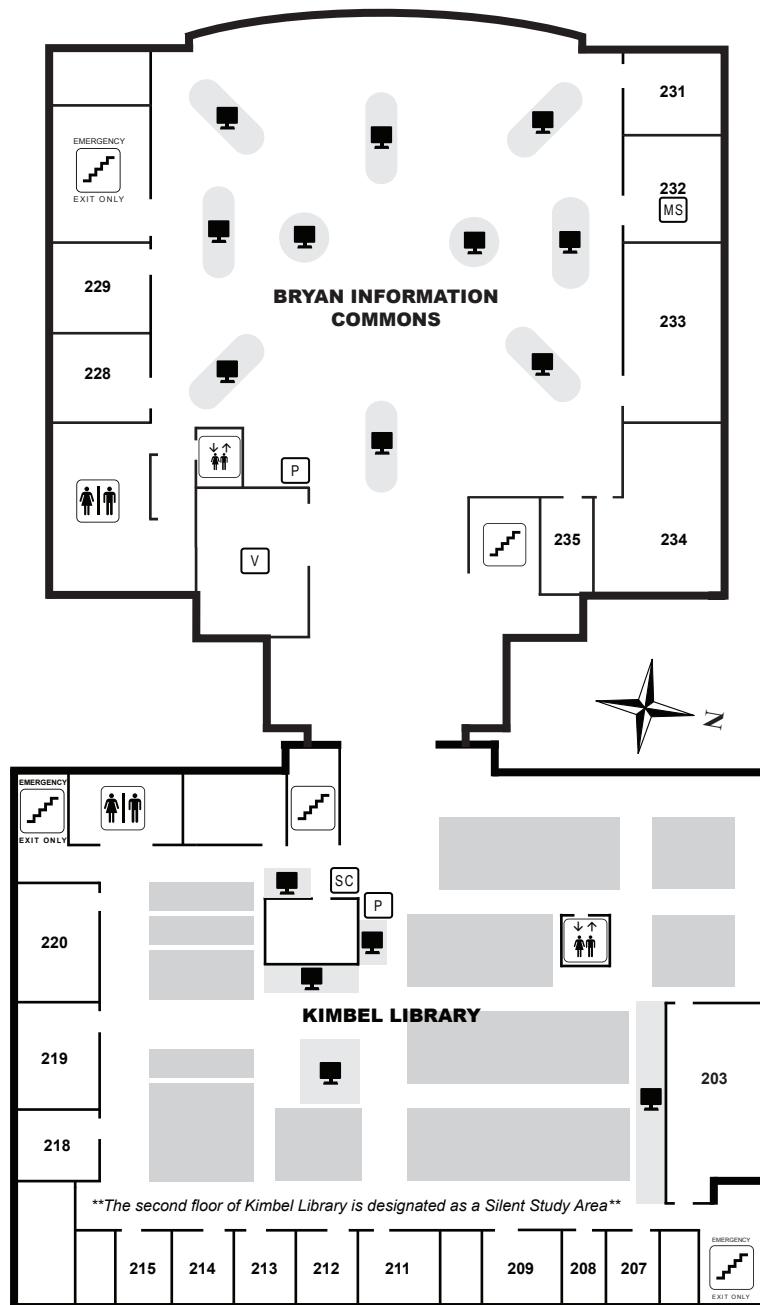

****The second floor of Kimbel Library is designated as a Silent Study Area****

MAP KEY

MS	Mediascape
SC	Self Checkout Station
P	Printing Station
V	Vending Machines
	Computer Workstations
	Restrooms
	Stairs
	Elevator
	Library Stacks

ROOM DIRECTORY

203	Tutoring Room
207-215	Group Study Rooms
218	Presentation Room
219	Library Instruction
220	Horry County Archives Center
228	Group Study Room
229	Group Study Room
231	Group Study Room
232	Group Study Room
233	Presentation Room
234	Instruction Lab
235	Research Office